

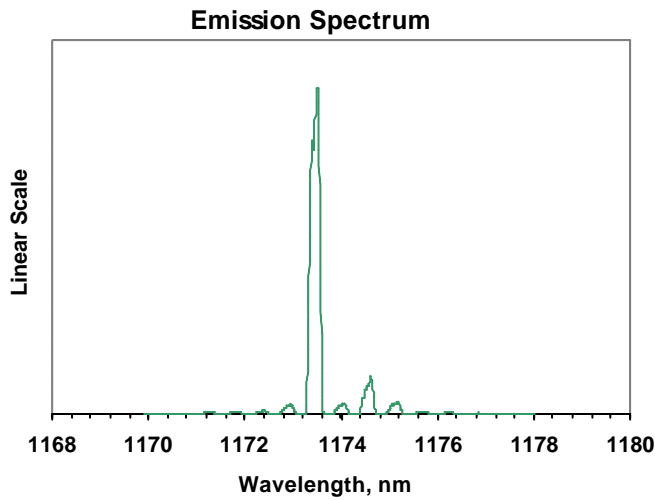

MODEL	QLD-1170-10S
PART NUMBER	SAMPLE

Parameter	Value	Units
Case Temperature	25	°C
Optical Output Power	10	mW
Threshold Current	39	mA
Operating Current	66	mA
Operating Voltage	1.41	V
Monitor Current	0.01	mA
Monitor Dark Current	0	nA
Center Wavelength	1174	nm
Spectral Width	0.87	nm

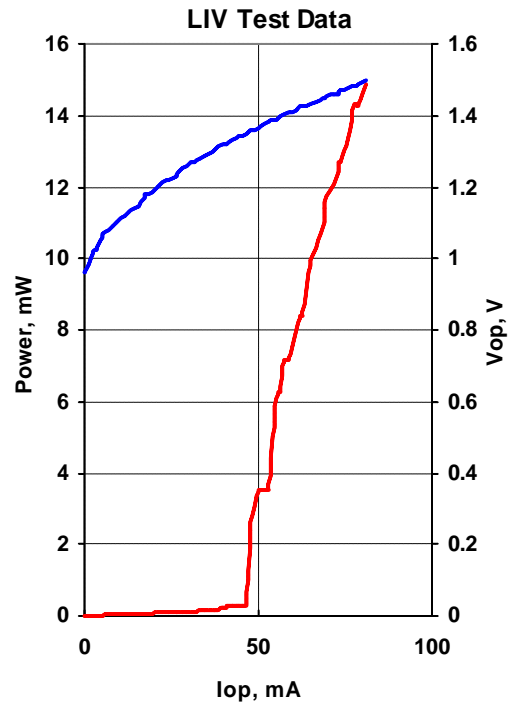

NOTE
This type of laser diodes must be used with temperature controlled mount.

Pin	Connection
1	LD Cathode
2	LD Anode, PD Cathode
3	PD Anode

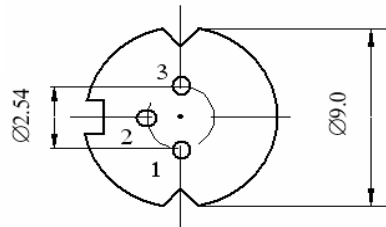

Operator	NA
Date	8/24/2007

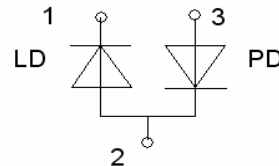

BOTTOM VIEW