



**QPHOTONICS, LLC**

3830 Packard Road,  
Suite 280,  
Ann Arbor, MI 48108,  
USA

Phone: 734-477-0133  
Fax: 734-477-0166  
Email: info@qphotonics.com  
http://www.qphotonics.com

<b>MODEL</b>	QLD-980-300S
<b>PART NUMBER</b>	SAMPLE

Parameter	Value	Units
Case Temperature	25	°C
Optical Output Power	300.1	mW
Threshold Current	42	mA
Operating Current	325	mA
<b>Maximum Operating Current</b>	<b>358</b>	<b>mA</b>
Operating Voltage	1.67	V
Monitor Current	0.19	mA
Center Wavelength	976.3	nm
Spectral Width	0.41	nm

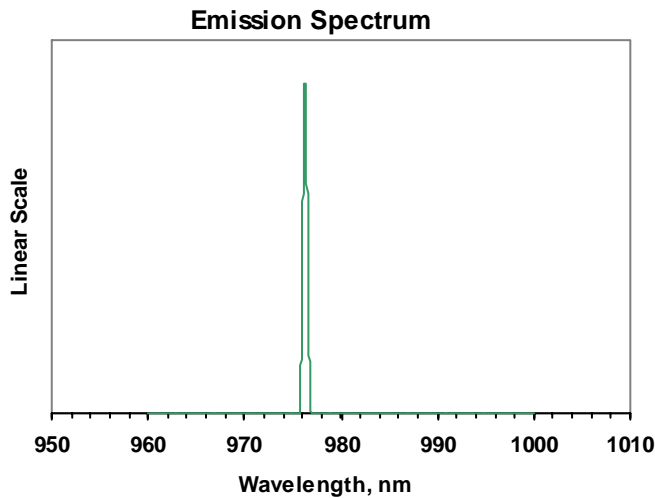
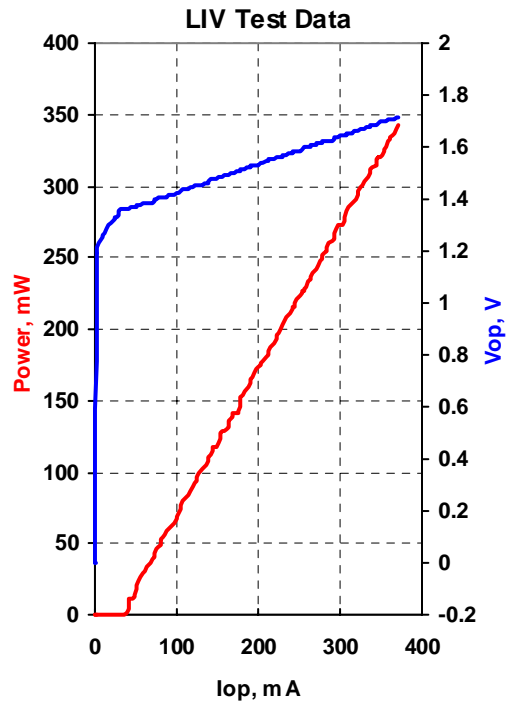

**NOTE**  
This type of laser diodes must be used with temperature controlled mount.

Pin	Connection
1	LD Anode
2	LD Cathode, PD Anode
3	PD Cathode

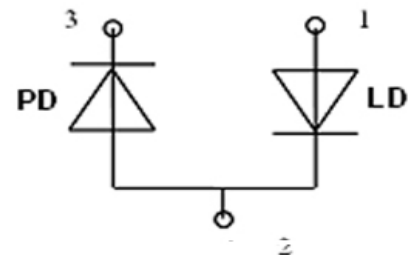
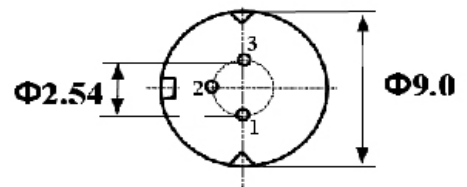

<b>Operator</b>	
<b>Date</b>	

**BOTTOM VIEW**